

*Four Winds*<sup>®</sup>  
BY THOR MOTOR COACH



 **THOR**<sup>®</sup>  
MOTOR COACH

Made to fit.

# Floor Plans

22B

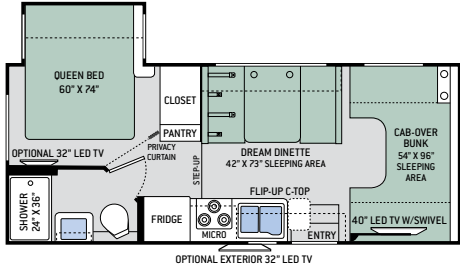

22E

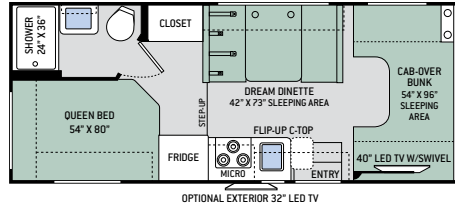

23U

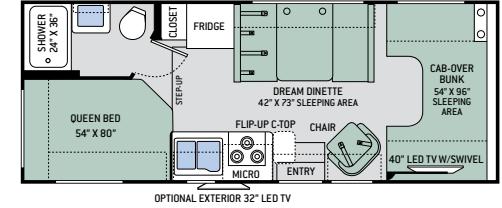

24F **NEW**

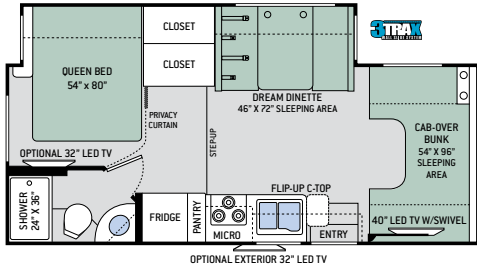

26B

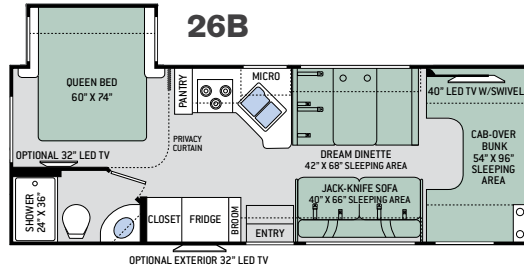

28Z

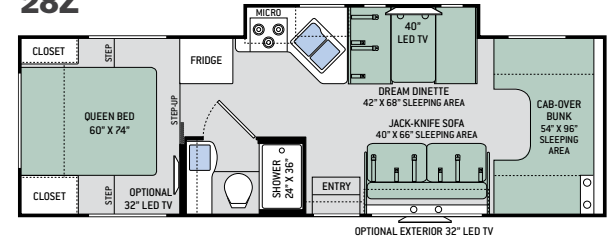

29G

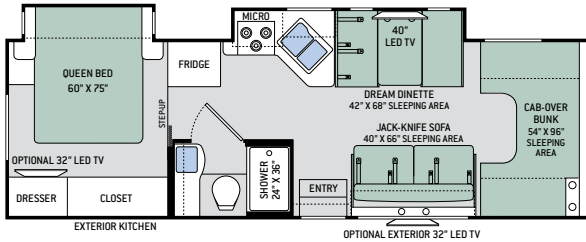

30D

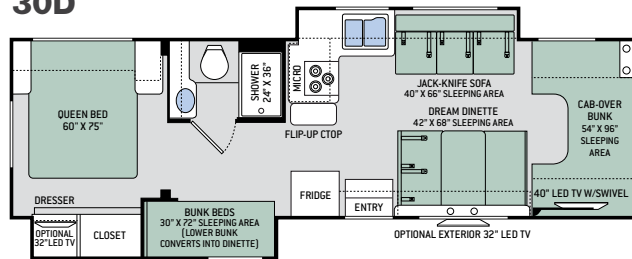

31E

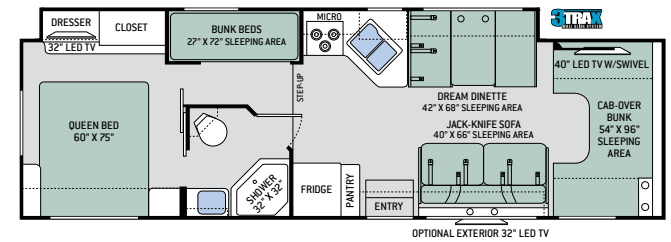

31L

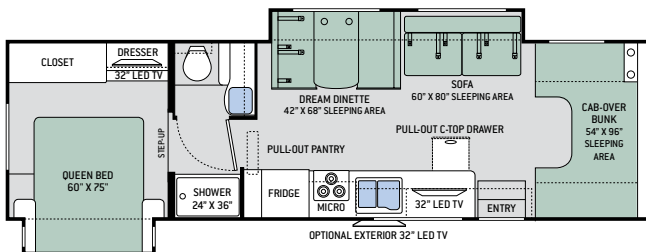

31W

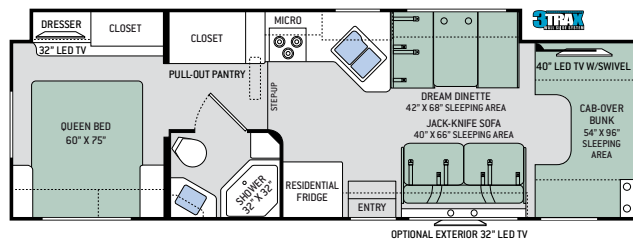

3TRAX™ is our in-wall slideout system, housing all the moving and mechanical parts within the sidewall of the motorhome. This triple track design supports large rooms, like those found in full-wall slideouts, ensuring simple, reliable, maintenance-free operation. What sets 3TRAX™ apart is the patented rail system, in-floor roller guides and electric motor design. For more information, visit [thormotorcoach.com/3TRAX](http://thormotorcoach.com/3TRAX).



# Interior Decor



GEMSTONE

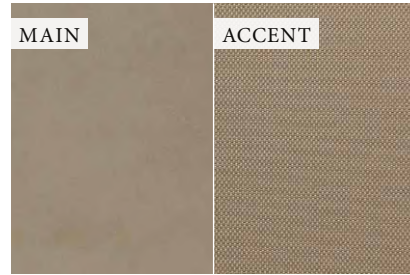

OPTIONAL LEATHERETTE



RESIDENTIAL VINYL FLOORING



LAGUNA SLATE



COUNTERTOPS



BRAZILIAN CHERRY SYDNEY MAPLE



SMOKED TRUFFLE



31E, 31L & 31W COUNTERTOPS



BRAZILIAN CHERRY SYDNEY MAPLE  
(31E, 31L & 31W)

# Exterior Graphics



STANDARD GRAPHICS



HOUSE OF BLUES



ORANGE CRUSH

# Specifications

<sup>\*</sup>Without Exterior Kitchen

	22B	22E	23U	24F	26B	28Z	29G	30D	31E	31L	31W
Chassis	Ford / Chevy	Ford / Chevy	Ford / Chevy	Ford / Chevy	Ford / Chevy	Ford	Ford	Ford	Ford	Ford	Ford
Gross Vehicle (GVWR)	14,500 / 12,300	14,500 / 12,300	14,500 / 12,300	14,500 / 14,200	14,500 / 12,300	14,500	14,500	14,500	14,500	14,500	14,500
Gross Combined (GCWR)	22,000 / 16,000	22,000 / 16,000	22,000 / 16,000	22,000 / 20,000	22,000 / 16,000	22,000	22,000	22,000	22,000	22,000	22,000
Wheel Base	158" / 159"	158" / 159"	158" / 159"	168" / 169"	183" / 184"	212"	212"	223"	223"	223"	223"
Exterior Length (w/o ladder)	24' / 24'-6"	24' / 24'-6"	24'-10" / 25'-4"	24'-11" / 25'-5"	27'-6" / 28'	29'-11"	29'-11"	32'-2"	32'-7"	32'-7"	32'-2"
Exterior Height (w/AC)	10'-10"	10'-10"	10'-10"	11'-1"	10'-10"	10'-10"	10'-10"	10'-10"	11'-1"	11'-1"	11'-1"
Exterior Width (w/o mirrors)	99"	99"	99"	99"	99"	99"	99"	99"	99"	99"	99"
Interior Height (living area)	84"	84"	84"	84"	84"	84"	84"	84"	84"	84"	84"
Awning Size	15'	15'	15'	16'	18'	14'	14'	10'-6"	16'	16'	16'
Fuel (gal)	55 / 57	55 / 57	55 / 57	55 / 57	55 / 57	55	55	55	55	55	55
LPG (lbs)	40.9	40.9	40.9	40.9	40.9	40.9	40.9	40.9	40.9	40.9	40.9
Fresh/Waste/Gray Water (gal)	40 / 24.5 / 37	40 / 24.5 / 37	40 / 24.5 / 38.5	40 / 32.5 / 37	40 / 26 / 26	40 / 26 / 32	39 / 26 / 32	40 / 29 / 31	40 / 28 / 28	40 / 31 / 29	40 / 28 / 28
Water Heater (gal)	6	6	6	6	6	6	6	6	6	6	6
Furnace (BTUs)	19,000	19,000	19,000	30,000	30,000	30,000	30,000	30,000	30,000	30,000	30,000
Exterior Storage Capacity (cu. ft.)	30.9	50.3	69.5	40	40	98.9	46.7 / 71.9 <sup>*</sup>	62.4	56.2	65.9	62.9

# Features

## CONSTRUCTION & EXTERIOR

- Ford® E-Series or Chevrolet® Dually Chassis (22B, 22E, 23U, 24F & 26B)
- Ford® E-Series Chassis (28Z, 29G, 30D, 31E, 31L & 31W)
- Electric Stabilizing System (24F)
- Premium One-Piece TPO Roof 
- Slick Fiberglass Exterior with Standard Graphics Package
- MEGA-Storage™ Compartment (22B, 22E, 23U, 28Z, 29G & 30D)
- Flush Mount Radius Compartment Doors
- Power Patio Awning with Integrated LED Lighting
- 3TRAX™ Wall Slide System (31E & 31W)
- Framed Windows (22B, 22E, 23U, 24F, 26B, 28Z, 29G & 30D)
- Frameless Windows (31E, 31L & 31W)
- 8,000-lb. Trailer Hitch with 7-pin Round Connector

## CONSTRUCTION & EXTERIOR OPTIONS

- HD-MAX® Exterior with Graphics Package
- Automatic Leveling Jacks (OPT 29G & 31L / STD 31E & 31W)

## AUTOMOTIVE & COCKPIT

- AM/FM Dash Radio with CD Player & Bluetooth® (22B, 22E, 23U, 24F, 26B & 30D)
- Deluxe Exterior Mirrors
- Power Windows & Door Locks
- Cruise Control
- Windshield Privacy Curtain
- Aluminum Running Boards

## AUTOMOTIVE & COCKPIT OPTIONS

- Heated/Remote Exterior Mirrors with Integrated Side View Cameras (Requires Back-up Monitor)
- Touchscreen AM/FM Dash Radio with CD/DVD Player, Bluetooth® & Back-Up Monitor (STD 28Z, 29G, 31E, 31L & 31W)
- Wood Dash Applique
- Leatherette Captain's Chairs

- Power Driver's Seat (28Z, 29G, 31E, 31L & 31W)
- Emergency Engine Start Switch
- Cockpit Carpet Mat
- Keyless Entry & Valve Stem Extenders (STD 28Z, 29G, 31E, 31L & 31W)
- Wheel Liners (STD 28Z, 29G, 31E, 31L & 31W)
- Spare Tire

## INTERIOR

- Rubber Tread Entry Steps with Lighted Step Well
- Residential Vinyl Flooring Throughout
- Ceiling Ducted Air Conditioning System (24F, 26B, 28Z, 29G, 30D, 31E, 31L & 31W)
- LED Lighting
- Window Privacy Shades
- Cab-Over Bunk Ladder
- Fabric Barrel Chair (23U)
- Fabric Jack-Knife Sofa (26B, 28Z, 29G, 30D, 31E & 31W)
- Leatherette Tri-Fold Sofa (31L)
- Fabric Dream Dinette® Booth

## INTERIOR OPTIONS

- Leatherette Jack-Knife Sofa (26B, 28Z, 29G, 30D, 31E & 31W)
- Leatherette Dream Dinette® Booth
- Single Child Safety Tether in Dinette
- Dual Child Safety Tethers in Dinette
- 12-volt Attic Fan w/Cover in Cab-Over Bunk

## KITCHEN

- Double Door Refrigerator (N/A 31W)
- 16 cu. ft. Residential Refrigerator w/Ice Maker (31W)
- 3-Burner Gas Cooktop
- Microwave Oven
- Waste Basket
- Pop-Up Countertop Outlet (31E, 31L, 31W)
- Laminate Countertops

- Large, Double Bowl Stainless Steel Sink (N/A 22E)
- Pantry (22B, 24F, 26B, 31E, 31L & 31W)

## KITCHEN OPTIONS

- 3-Burner Gas Cooktop with Oven (STD 28Z, 29G, 31E, 31L & 31W)
- Convection Microwave Oven (N/A 31E, 31L & 31W)

## BEDROOM & BATHROOM

- Denver Mattress® Queen Size Bed with Bedspread and Pillow Shams
- Bunk Beds (30D & 31E)
- Porcelain Toilet
- Shower with Curtain (22B & 22E)
- Shower with Retractable Door (23U, 24F, 26B, 28Z, 29G & 30D)

## BEDROOM & BATHROOM OPTION

- 12-volt Attic Fan with Cover in Bedroom

## ENTERTAINMENT

- 40" LED TV on Manual Swivel in Cab-Over (22B, 22E, 23U, 24F, 26B, 30D, 31E & 31W)
  - 40" LED TV in Living Area (28Z & 29G)
  - 32" LED TV & DVD Player in Living Area (31L)
  - Blu-Ray Player
  - Two (2) 13" LED TVs & DVD Player in Bunk Bed Area (31E)
  - Bluetooth® Coach Radio with Exterior Speakers (28Z, 29G, 31E, 31L & 31W)
  - Power Charging Center for Electronics (28Z, 29G, 31E, 31L & 31W)
  - Cable TV Ready
  - Digital TV Antenna
  - Exterior Kitchen with 2.6 cu. ft. Refrigerator, Sink, Portable Gas Grill & 1000-watt Inverter (29G)
- ## ENTERTAINMENT OPTIONS
- Cab-Over Entertainment Center with 40" LED TV, Blu-Ray Player & Sound Bar IPO STD Living Area TV (31E, 31L & 31W)

- 32" LED TV in Bedroom (OPT 22B, 24F, 26B, 28Z, 29G & 30D / STD 31E, 31L & 31W)
- Two (2) 13" LED TVs & DVD Player in Bunk Bed Area (30D)
- Exterior 32" LED TV on Manual Swivel
- Storage Area with Shelf IPO Exterior Kitchen (29G)

## ELECTRICAL & PLUMBING

- Onan® RV QG 4000 Gas Generator
- Automatic Generator Start (31W)
- 30-amp Shoreline Power Cord
- 1800-watt Inverter (31W)
- Battery Tray for Four (4) Batteries (31E, 31L & 31W)
- 13,500 BTU Roof Front Air Conditioner
- 6-gallon DSI Gas/Electric Water Heater
- Water Heater Bypass System
- Rapid Camp® Wireless Control System (31E, 31L & 31W)

## ELECTRICAL & PLUMBING OPTIONS

- 15,000 BTU Roof Front Air Conditioner IPO 13,000 BTU Standard Air Conditioner
- Holding Tanks with Heat Pads (STD 28Z, 29G, 31E, 31L & 31W)
- Outside Shower (STD 31E, 31L & 31W)
- Second Auxiliary House Battery (STD 31W)

## PREMIER PACKAGE – STANDARD ON 31E, 31L & 31W

- 30" Over-the-Range Microwave Oven
- Solid Surface Kitchen Countertops & Sink Covers
- Shower with Glass Door
- Premium Window Privacy Roller Shades
- Whole Coach Water Filtration System
- Enclosed Sewer Area for Sewer Tank Valves
- Black Tank Flush System

**IMPORTANT—PLEASE READ:** This brochure reflects product design, fabrication, material, components and specifications at the date of printing, which date is disclosed below. Please visit us online at [ThorMotorCoach.com](http://ThorMotorCoach.com) or consult with your selling dealership for the latest in standards, options, specification and technical information. Photographs in the brochure may depict optional equipment or may only be available in certain floor plans. Components, appliances and the chassis may have been manufactured in a calendar year before the vehicle's designated model year. All capacities are approximate. The actual length of the vehicle may differ from that indicated in the brochure due to variances in the manufacturing processes and/or installed components. All dry weights are based on standard model features and do not include optional features or equipment. Component part and appliance manufacturers issue limited warranties covering portions of the vehicle not covered under the limited warranty we issue. Copyright Thor Motor Coach, Inc. © OH 10/01/16

YOUR LOCAL THOR MOTOR COACH DEALER



Made to fit.

[thormotorcoach.com/fourwinds](http://thormotorcoach.com/fourwinds)

P.O. Box 1486, Elkhart, IN 46515 Sales Department: 800.860.5658 Customer Service: 877.855.2867





*Four Winds*<sup>®</sup>  
SUPER C BY THOR MOTOR COACH



 **THOR**<sup>®</sup>  
MOTOR COACH

Made to fit.

# Floor Plans

## 35SB

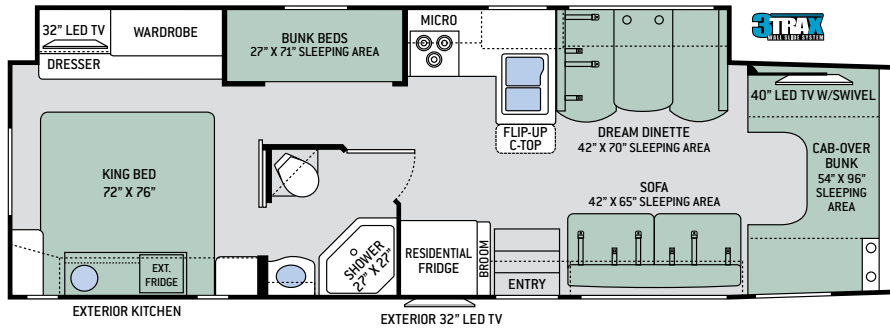

## 35SD

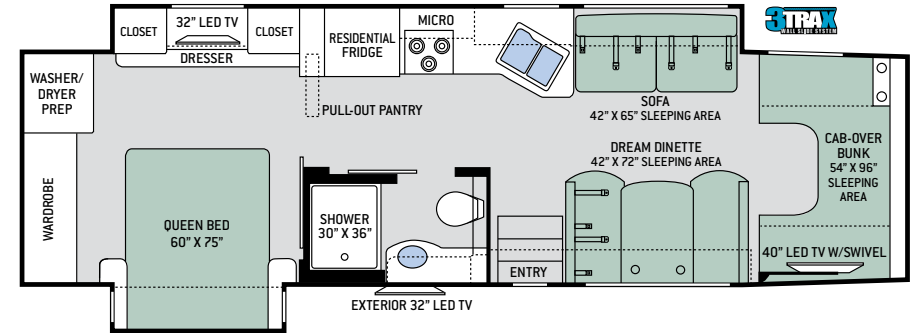

## 35SF

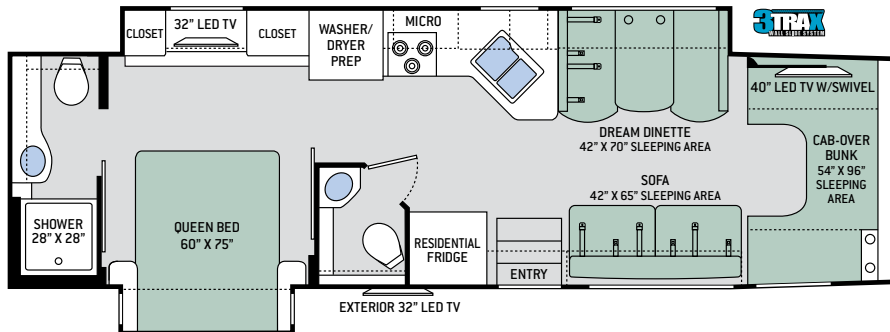

## 35SM

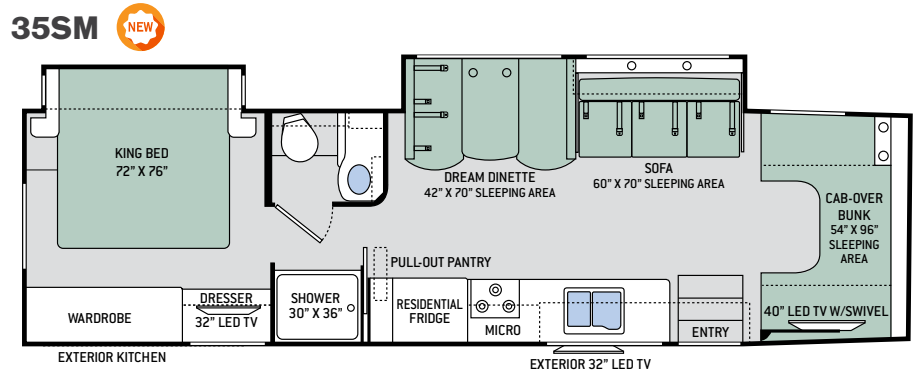

# Specifications

	35SB	35SD	35SF	35SM
Chassis	Ford	Ford	Ford	Ford
Gross Vehicle (GVWR)	19,500	19,500	19,500	19,500
Gross Combined (GCWR)	35,000	35,000	35,000	35,000
Wheel Base	245"	255"	255"	255"
Exterior Length (w/o ladder)	35'-11"	36'-2"	36'-2"	36'-2"
Exterior Height (w/ AC)	12'-6"	12'-6"	12'-6"	12'-6"
Exterior Width (w/o mirrors)	99"	99"	99"	99"
Interior Height (living area)	84"	84"	84"	84"
Awning Size	19'	14'	14'	16'
Front/Rear Fuel (gal)	40 / 28	40 / 28	40 / 28	40 / 28
LPG (lbs)	68.2	68.2	68.2	68.2
Fresh/Waste/Gray Water (gal)	75 / 40 / 40	75 / 40 / 40	75 / 40F- 31R / 40	75 / 40 / 40
Water Heater (gal)	6	6	6	6
Furnace (BTUs)	30,000	30,000	30,000	30,000
Exterior Storage Capacity (cu. ft.)	93 / 128*	100	117	109 / 134*

\*Without Exterior Kitchen



3TRAX™ is our in-wall slideout system, housing all the moving and mechanical parts within the sidewall of the motorhome. This triple track design supports large rooms, like those found in full-wall slideouts, ensuring simple, reliable, maintenance-free operation. What sets 3TRAX™ apart is the patented rail system, in-floor roller guides and electric motor design.



# Interior Decor



KEY LARGO II

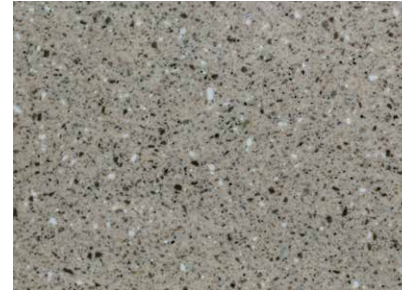

KITCHEN & DINETTE  
COUNTERTOP



HIGH-GLOSS GLAZED  
MILAN CHERRY



POMPANO BEACH II



BED & BATH COUNTERTOP



HIGH-GLOSS GLAZED  
PACIFIC CHERRY



SONOMA II



RESIDENTIAL VINYL FLOORING



HIGH-GLOSS GLAZED  
RESORT CHERRY

# Exterior Graphics



MAPLE LEAF FULL-BODY PAINT



PACIFICA FULL-BODY PAINT

# Features

## CONSTRUCTION & EXTERIOR

- Ford® F-550 Chassis – 6.7L Power Stroke® V8 Turbo Diesel, 300HP & 660 lb.-ft. Torque – TorqShift® 6-Speed SelectShift® Automatic Transmission
- Welded Tubular Steel Floor
- Welded Tubular Aluminum Roof & Sidewall Cage Construction
- Premium One-Piece TPO Roof 
- Full-Body Paint Package with Gel Coated Sidewalls
- Automatic Leveling Jacks with Touchpad Controls
- Rotocast Storage Compartments
- Flush Mount Radius Compartment Doors
- Power Patio Awning with Integrated LED Lighting
- Slideout Room Awnings
- 3TRAX™ Wall Slide System (35SB, 35SD & 35SF)
- Roof Ladder
- Patio Light
- Electric Entry Step
- Lighted Exterior Grab Handle
- Frameless Slider Windows
- 10,000-lb. Trailer Hitch with 7-pin Round Connector

## AUTOMOTIVE & COCKPIT

- Touchscreen AM/FM Dash Radio with CD/DVD Player, Bluetooth® & Back-Up Monitor
- Chrome, Heated/Remote Exterior Mirrors w/Side View Camera System
- Luxury Cloth Captain's Chairs with 4-Way Adjustable Headrest
- Power Adjustable Driver's Seat
- Emergency Engine Start Switch
- Adjustable Accelerator & Brake Pedals
- Power Windows & Door Locks
- Keyless Entry System
- Windshield Privacy Curtain
- Fiberglass Running Boards
- Valve Stem Extenders
- Stainless Steel Wheel Liners

**IMPORTANT—PLEASE READ:** This brochure reflects product design, fabrication, material, components and specifications at the date of printing, which date is disclosed below. **Please visit us online at [ThorMotorCoach.com](http://ThorMotorCoach.com) or consult with your selling dealership for the latest in standards, options, specification and technical information.** Photographs in the brochure may depict optional equipment or may only be available in certain floor plans. Components, appliances and the chassis may have been manufactured in a calendar year before the vehicle's designated model year. All capacities are approximate. The actual length of the vehicle may differ from that indicated in the brochure due to variances in the manufacturing processes and/or installed components. All dry weights are based on standard model features and do not include optional features or equipment. Component part and appliance manufacturers issue limited warranties covering portions of the vehicle not covered under the limited warranty we issue. Copyright Thor Motor Coach, Inc. © OH 10/01/16

## INTERIOR

- Rubber Tread Entry Steps with Lighted Step Well
- Residential Vinyl Flooring Throughout
- 84" Interior Ceiling Height
- LED Lighting
- Ceiling Ducted Air Conditioning System
- High-Gloss Glazed Cabinetry with Solid Wood Raised Cabinet Doors, Hidden Hinges & Nickel Finish Hardware
- Window Solar & Privacy Roller Shades in Living Room
- Leatherette Sleeper Sofa
- Leatherette Dream Dinette® Booth
- Pressed Laminate Countertops

## INTERIOR OPTIONS

- Single Child Safety Tether in Dinette
- Dual Child Safety Tethers in Dinette
- 12-volt Attic Fan with Cover in Cab-Over

## KITCHEN

- 16 cu. ft. Stainless Steel Residential Refrigerator w/Ice Maker
- 3-Burner Gas Cooktop with Oven
- Stainless Steel 30" Over-the-Range Microwave Oven
- Solid Surface Countertops & Sink Covers
- Stainless Steel Double Bowl Sink with Single Handle Faucet & Pull-Down Sprayer
- Pop-Up Countertop Outlet
- Pantry (35SD & 35SM)
- Waste Basket

## KITCHEN OPTION

- 12-volt Attic Fan with Cover (35SB, 35SD & 35SF)

## BEDROOM & BATHROOM

- Denver Mattress® King Size Bed (35SB & 35SM)
- Denver Mattress® Queen Size Bed (35SD & 35SF)
- Headboard, Bedspread & Pillow Shams
- Window Privacy Shades in Bedroom
- Bunk Beds in Hallway Slideout (35SB)
- Shower with Glass Door
- Stainless Steel Bathroom Sink
- Porcelain Toilet

YOUR LOCAL THOR MOTOR COACH DEALER



## ENTERTAINMENT

- 40" LED TV on Manual Swivel in Cab-Over (35SB, 35SD & 35SF)
- Blu-Ray Player in Living Area
- 32" LED TV in Bedroom
- Two (2) 13" LED TVs & DVD Player in Bunk Bed Area (35SB)
- Exterior 32" LED TV on Manual Swivel
- Bluetooth® Coach Radio System with Exterior Speakers
- Cable TV Ready
- Digital TV Antenna
- Power Charging Center for Electronics
- Exterior Kitchen with 2.6 cu. ft. Refrigerator, Sink & Portable Gas Grill (35SB & 35SM)

## ENTERTAINMENT OPTIONS

- Cab-Over Entertainment Center with 50" LED TV & Sound Bar (IPO 40" LED TV)
- Storage Area with Shelf IPO Exterior Kitchen (35SB & 35SM)

## ELECTRICAL & PLUMBING

- Onan® RV QG 6000 Diesel Generator
- Automatic Generator Start
- 50-amp Detachable Shoreline Power Cord
- Automatic Shoreline-to-Generator Transfer Switch
- 1800-watt Inverter
- Dual 13,500 BTU Roof Air Conditioners
- Dual Auxiliary House Batteries with Battery Tray that Holds up to Four (4) Batteries
- Battery Disconnect Switch
- Whole Coach Water Filtration System
- 6-gallon DSI Gas/Electric Water Heater
- Water Heater Bypass System
- Enclosed & Heated Holding Tanks
- Black Tank Flush System
- Exterior LP Quick Hook-Up Connection
- Outside Shower
- Systems Control Center
- Rapid Camp® Wireless Control System



**Made to fit.**





*Four Winds*<sup>®</sup>  
SPRINTER BY THOR MOTOR COACH



 **THOR**<sup>®</sup>  
MOTOR COACH

Made to fit.

# Floor Plans



## 24FS

Chassis	Mercedes-Benz Sprinter
Gross Vehicle (GVWR)	11,030
Gross Combined (GCWR)	15,250
Wheel Base	170.3"
Exterior Length (w/o ladder)	24'-8"
Exterior Height (w/ AC)	11'-7"
Exterior Width (w/o mirrors)	90"
Interior Height (living area)	84"
Awning Size	15'
Fuel (gal)	26.4
LPG (lbs)	68.2
Fresh/Waste/Gray Water (gal)	30 / 24 / 38
Water Heater (gal)	Tankless
Furnace (BTUs)	30,000
Exterior Storage Capacity (cu. ft.)	48.5

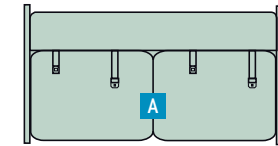
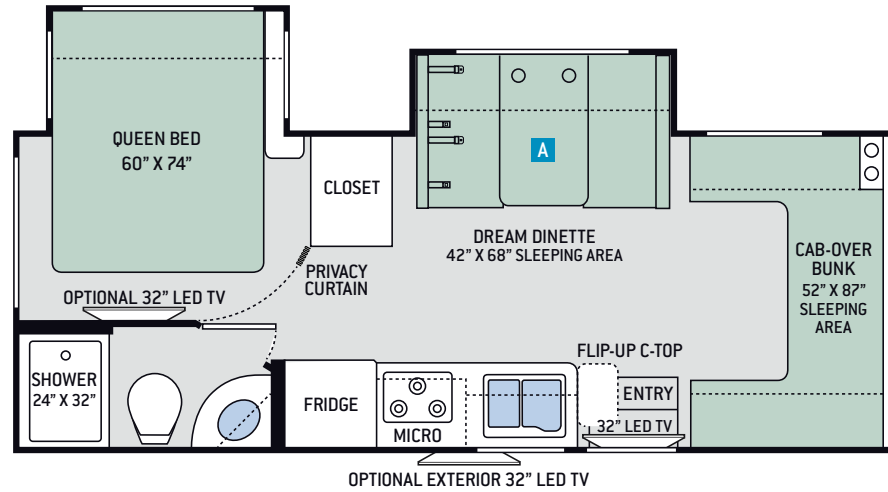

OPTIONAL JACK-KNIFE SOFA  
42" X 70" SLEEPING AREA

## 24HL

Chassis	Mercedes-Benz Sprinter
Gross Vehicle (GVWR)	11,030
Gross Combined (GCWR)	15,250
Wheel Base	170.3"
Exterior Length (w/o ladder)	24'-11"
Exterior Height (w/ AC)	11'-7"
Exterior Width (w/o mirrors)	90"
Interior Height (living area)	84"
Awning Size	16'
Fuel (gal)	26.4
LPG (lbs)	68.2
Fresh/Waste/Gray Water (gal)	30 / 25 / 24
Water Heater (gal)	Tankless
Furnace (BTUs)	30,000
Exterior Storage Capacity (cu. ft.)	77.7

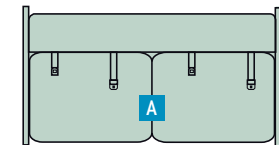
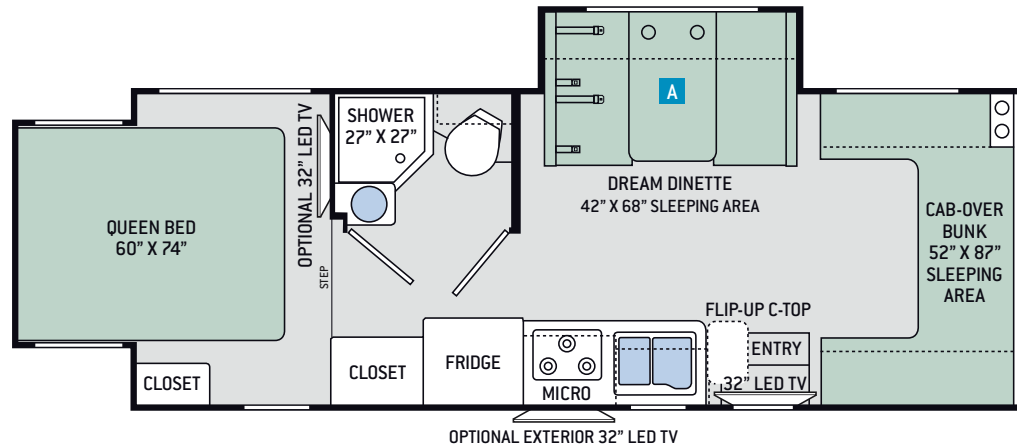

OPTIONAL JACK-KNIFE SOFA  
42" X 70" SLEEPING AREA



# Interior Decor



GEMSTONE



LAGUNA SLATE



SMOKED TRUFFLE



BRAZILIAN CHERRY



SYDNEY MAPLE

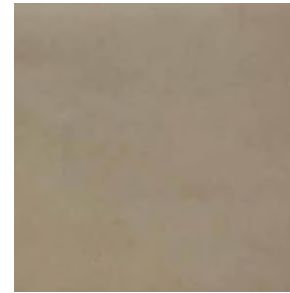

OPTIONAL  
LEATHERETTE



COUNTERTOPS



RESIDENTIAL VINYL  
FLOORING

# Exterior Graphics



STANDARD GRAPHICS



HOUSE OF BLUES 



ORANGE CRUSH 

# Features

## CONSTRUCTION & EXTERIOR

- Mercedes-Benz Sprinter Diesel Chassis
- Welded Tubular Steel Floor
- Welded Tubular Aluminum Roof & Sidewall Cage Construction
- Vacu-Bond Laminated Roof, Walls & Floor with Block Foam Insulation
- Premium One-Piece TPO Roof 
- One-Piece Fiberglass Front Cap
- Slick Fiberglass Exterior with Standard Graphics Package
- MEGA-Storage™ Compartment (24HL)
- Rotocast Storage Compartments
- Flush Mount Radius Compartment Doors
- Power Patio Awning with Integrated LED Lighting
- Slideout Room Topper Awnings
- Patio Light
- Roof Ladder (24FS)
- Electric Entry Step
- Framed Slider Radius Windows
- 5,000-lb. Trailer Hitch
- Electric Stabilizing System (24FS)

## CONSTRUCTION & EXTERIOR OPTION

- HD-MAX® Exterior with Graphics Package

## AUTOMOTIVE & COCKPIT

- Touchscreen AM/FM Dash Radio with CD/DVD Player, Bluetooth® & Back-up Monitor
- Deluxe Heated/Remote Exterior Mirrors
- Swivel, Leatherette Captain's Chairs
- Driver & Passenger Air Bags
- Cruise Control
- Tilt Steering Wheel
- Power Windows & Door Locks
- Keyless Entry System
- Windshield Privacy Curtain
- Stainless Steel Wheel Liners

**IMPORTANT—PLEASE READ:** This brochure reflects product design, fabrication, material, components and specifications at the date of printing, which date is disclosed below. Please visit us online at [ThorMotorCoach.com](http://ThorMotorCoach.com) or consult with your selling dealership for the latest in standards, options, specification and technical information. Photographs in the brochure may depict optional equipment or may only be available in certain floor plans. Components, appliances and the chassis may have been manufactured in a calendar year before the vehicle's designated model year. All capacities are approximate. The actual length of the vehicle may differ from that indicated in the brochure due to variances in the manufacturing processes and/or installed components. All dry weights are based on standard model features and do not include optional features or equipment. Component part and appliance manufacturers issue limited warranties covering portions of the vehicle not covered under the limited warranty we issue. Copyright Thor Motor Coach, Inc. © OH 10/01/16

- Valve Stem Extensions on All Wheels

## AUTOMOTIVE & COCKPIT OPTION

- 12-volt Attic Fan with Cover in Cab-Over

## INTERIOR

- Rubber Tread Entry Steps with Lighted Step Well
- Residential Vinyl Flooring Throughout
- 84" Interior Ceiling Height
- LED Ceiling Lighting
- Ceiling Ducted Air Conditioning System
- Cab-Over Bunk Ladder
- Fabric Dream Dinette® Booth
- Laminate Countertops
- Raised Panel Cabinet Doors & Nickel Finish Hardware
- Full Extension Metal Ball-Bearing Drawer Guides
- Window Privacy Roller Shades

## INTERIOR OPTIONS

- Leatherette Dream Dinette® Booth
- Leatherette Jack-Knife Sofa & Removable Pedestal Table
- Single Child Safety Tether in Dinette
- Dual Child Safety Tether in Dinette

## KITCHEN

- 6 cu. ft. Double Door Refrigerator
- 3-Burner Gas Cooktop
- Convection Microwave Oven
- Flip-Up Countertop Extension
- Stainless Steel Double Bowl Sink & Single Handle Faucet w/Pull-Down Sprayer
- Waste Basket

## KITCHEN OPTION

- 3-Burner Gas Cooktop with Oven

## BEDROOM & BATHROOM

- Denver Mattress® Queen Size Bed
- Bedspread and Pillow Shams
- Shower with Curved Rod & Curtain (24HL)
- Shower with Retractable Door (24FS)
- Foot Flush Toilet

## BEDROOM & BATHROOM OPTION

- 12-volt Attic Fan with Cover in Bedroom

## ENTERTAINMENT

- 32" LED TV on Manual Swivel & Blu-Ray Player
- Cable TV Ready
- Digital TV Antenna

## ENTERTAINMENT OPTIONS

- 32" LED TV in Bedroom
- Exterior 32" LED TV on Manual Swivel

## ELECTRICAL & PLUMBING

- Onan® RV QG 3600 LP Generator
- 30-amp Shoreline Power Cord
- Automatic Shoreline-to-Generator Transfer Switch
- Battery Disconnect Switch
- 13,500 BTU Front Air Conditioner
- Instant Tankless Water Heater
- Enclosed & Heated Holding Tanks (24HL)
- Black Tank Flush System
- Sewer Hose Storage Area
- Outside Shower
- Systems Control Center

## ELECTRICAL & PLUMBING OPTIONS

- Onan® RV QD 3200 Diesel Generator
- Second Auxiliary House Battery
- Holding Tanks with Heat Pads (24FS)

YOUR LOCAL THOR MOTOR COACH DEALER



Made to fit.

[thormotorcoach.com/fourwinds-sprinter](http://thormotorcoach.com/fourwinds-sprinter)

P.O. Box 1486, Elkhart, IN 46515 Sales Department: 800.860.5658 Customer Service: 877.855.2867

